

# INPHENIX

## Semiconductor Optical Amplifier Device (Switch Type)

### IPSAD1513 (1550nm)

#### Features

- Wide Optical Bandwidth
- Fast Switching Speed
- High Extinction Ratio
- Low Polarization Sensitivity
- MQW or Bulk Structure

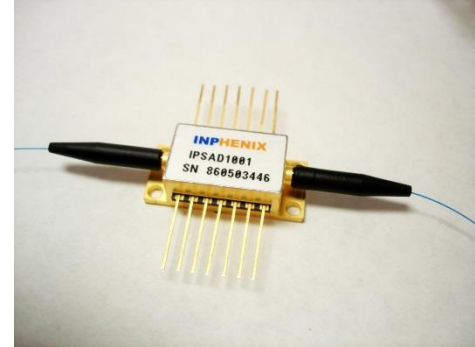

#### Applications

- Optical power Switching with Loss Compensation
- Wavelength Routing
- Matrix Switch

#### Device Specifications

Parameter	Symbol	Specifications			Unit	
		Min.	Typ.	Max.		
Drive Current	$I_F$	-	600	800	mA	
Operating Wavelength	$\lambda_o$	1528	-	1562	nm	
3dB Optical Bandwidth	$\Delta\lambda_{3dB}$	-	-	-	nm	
Small Signal Gain @ - 25dBm Signal	$G_{max}$	20	22	-	dB	
Gain Ripple with Respect to $\lambda$	$\Delta G$	-	1	3	dB	
Saturation Output Power	$P_{sat}$	13	-	-	dBm	
Noise Figure	NF	-	-	9.5	dB	
Polarization Dependent Gain	PDG	-	1	1.8	dB	
Extinction Ratio	ER	-	80	-	dB	
Switching Properties	Rise Time	$t_r$	-	1000	-	ps
	Fall Time	$t_f$	-	1000	-	ps



### Absolute Maximum Ratings

Parameter	Min.	Max.	Unit
Operating Temperature	- 20	70	°C
Storage Temperature	- 40	85	°C
SOA Forward Current	-	1000	mA
SOA Reverse Voltage	-	2.5	V
TEC Drive Current	-	1.5	A
TEC Drive Voltage	-	3.6	V
Thermistor Resistance	10kΩ @ 25°C		
SOA Chip Temperature Setting	25°C		
Fiber Type	SMF/PMF/MMF ClearCurve Fiber		
Fiber Jacket	250μm tight buffer with/without 900μm loose tube, or 900μm tight buffer		
Package	14-pin Butterfly		



**Package Dimensions**

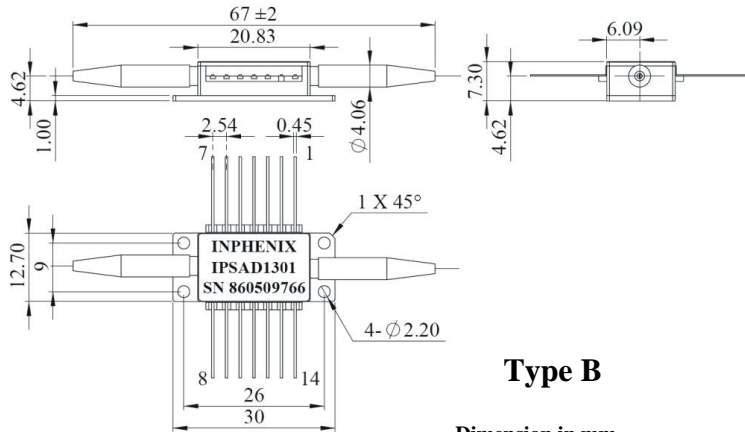

**Type B**

Dimension in mm  
Tol:  $\pm 0.13$

**Pin Definition**

Pin	14-pin Butterfly
1	TEC(+)
2	NC
3	Thermistor *
4	Thermistor *
5	NC
6	NC
7	NC
8	NC
9	NC
10	SOA(+)
11	SOA(-)
12	NC
13	Case
14	TEC(-)

Option: Pin 2 & Pin 5 for thermistor

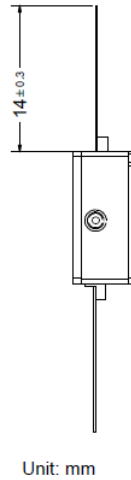
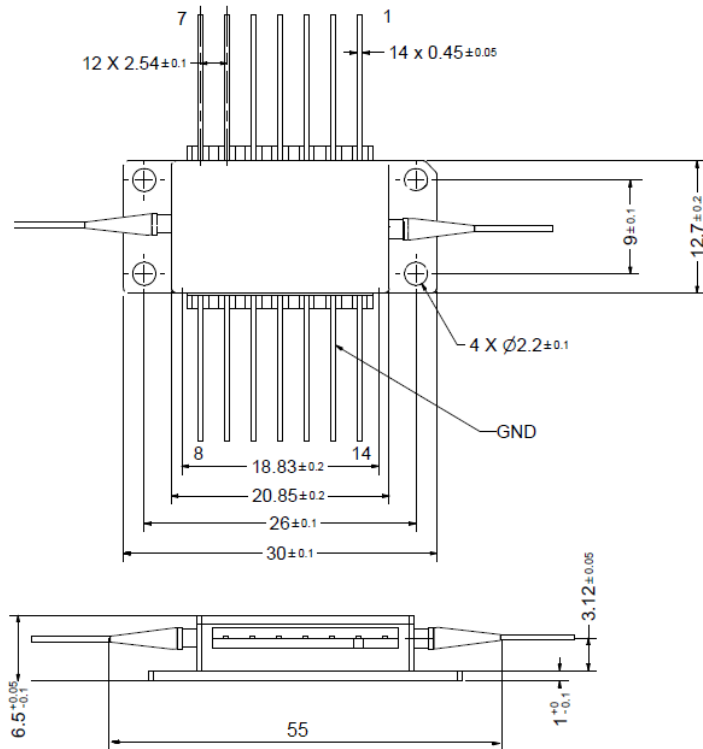

Unit: mm

Type C

Dimension in mm  
Tol: ±0.13

**Pin Definition**

Pin	14-pin Butterfly
1	TEC(+)
2	NC
3	Thermistor *
4	Thermistor *
5	NC
6	NC
7	NC
8	NC
9	NC
10	SOA(+)
11	SOA(-)
12	NC
13	Case
14	TEC(-)

Option: Pin 2 & Pin 5 for thermistor

# INPHENIX

## Part Numbering System

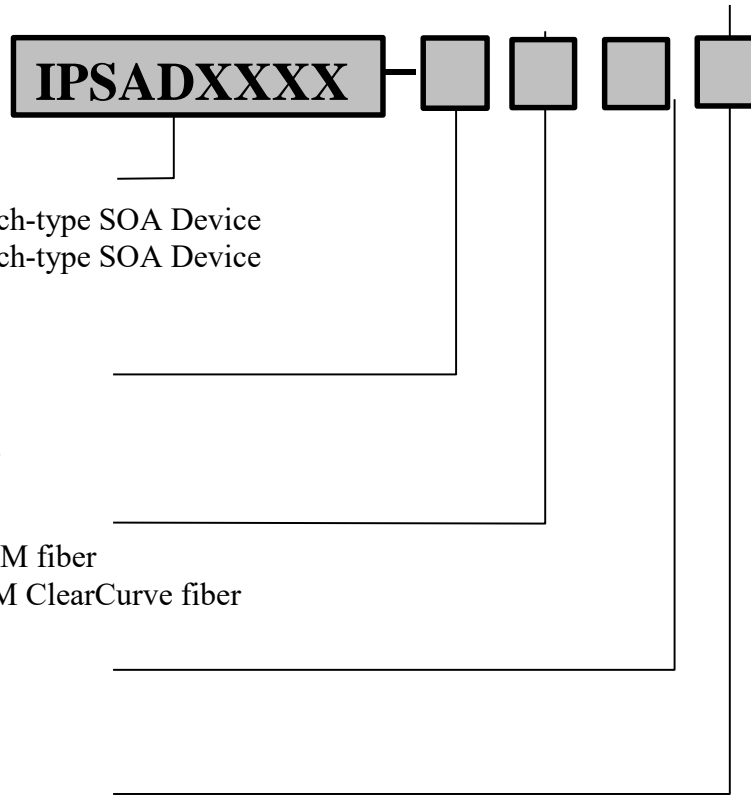

**Model:**

IPSAD1302: 1310nm Switch-type SOA Device  
 IPSAD1502: 1550nm Switch-type SOA Device

**Package:**

5: 14-pin Butterfly, Type B  
 6: 14-pin Butterfly, Type C

**Fiber Type:**

1: SM fiber                      3: MM fiber  
 2: PM fiber                    8: SM ClearCurve fiber

**Jacket Type:**

1: 900µm  
 2: 250µm

**Connector Type:**

0: No Connectors  
 3: FC/APC  
 4: FC/UPC  
 7: SC/APC  
 8: SC/UPC

**Example:** IPSAD1302-5110: 1310nm Switch-type SOA in 14-pin Butterfly Package with 900µm SM Fiber with no Connectors.

**Corporate Office**

250 North Mines Rd  
 Livermore, CA 94551  
 Tel: 925.606.8809  
 Fax: 925.606.8810  
[www.inphenix.com](http://www.inphenix.com)  
[sales@inphenix.com](mailto:sales@inphenix.com)