

Description: Violet superluminescent light emitting diode

Optical output power: 10 mW

Package: TO-56 **Product number:** EXS210015-01

Broadband light source with low etendue. Ideal for holography, metrology or spectroscopy. Can be used as tuneable laser when fit to external cavities.

Maximum ratings

| Parameter | Symbol | Min | Max | Unit |
|---------------------|-----------|-----|-----|------|
| Output power | P | - | 20 | mW |
| Forward current | I_F | | 200 | mA |
| Reverse voltage | V_R | | -2 | V |
| Forward voltage | V_F | | 7.0 | V |
| Storage temperature | T_{stg} | -40 | 85 | °C |

Operating characteristics (T_{case}: 25 °C; P: 10mW)

| Parameter | Symbol | Min | Typ | Max | Unit |
|-------------------|-----------------|-----|-----|-----|------|
| Forward current | I_F | - | - | 110 | mA |
| Forward voltage | V_F | - | 5.0 | 6.0 | V |
| Centre wavelength | λ | 400 | 405 | 410 | nm |
| 3dB bandwidth | $\Delta\lambda$ | 2.5 | 4 | - | nm |

Preliminary Specification: this product is currently under development. The datasheet contains preliminary data. Additional data may be added at a later date. EXALOS reserves the right to change specifications at any time without notice in order to supply the best possible product.



Drawings

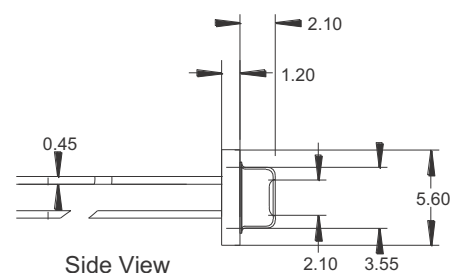

Side View

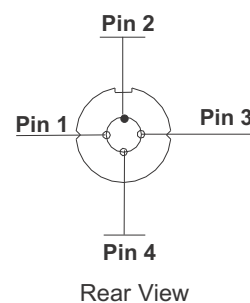

Rear View

| Pin | Function |
|-----|------------------------|
| 1 | SLED ANODE (+) |
| 2 | SLED CATHODE (-), CASE |
| 3 | Not connected |
| 4 | Not connected |

EXALOS AG

Wagistrasse 21 CH-8952 Schlieren, Switzerland

Tel. +41 43 444 60 90 Fax +41 43 444 60 99

sales@exalos.com

www.exalos.com

Typical characteristics:

These characteristics are relative to a particular device under test.
Device to device variations may occur on a different set of samples.

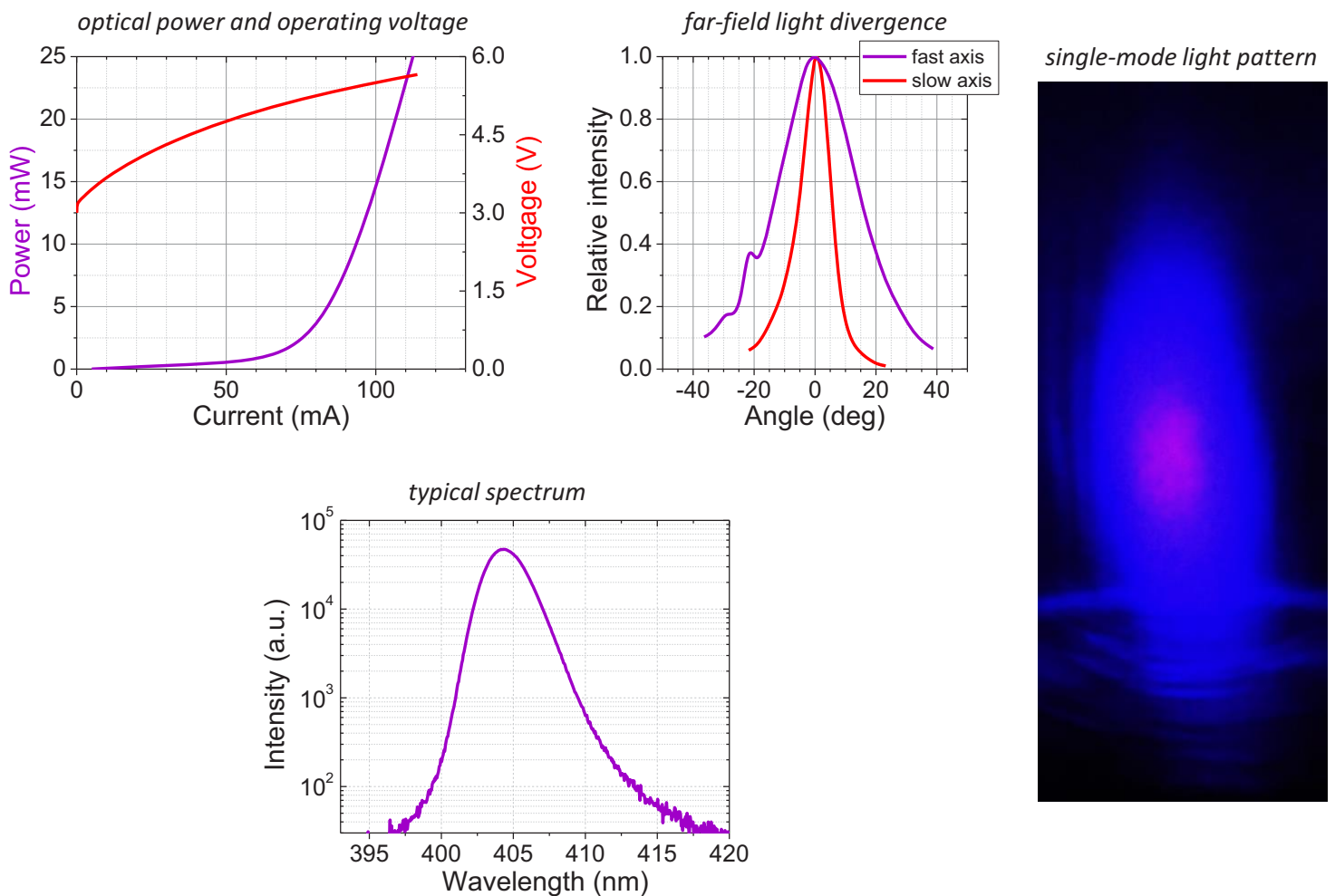

Preliminary Specification: this product is currently under development. The datasheet contains preliminary data. Additional data may be added at a later date. EXALOS reserves the right to change specifications at any time without notice in order to supply the best possible product.

EXALOS AG

Wagistrasse 21 CH-8952 Schlieren, Switzerland

Tel. +41 43 444 60 90 Fax +41 43 444 60 99

sales@exalos.com

www.exalos.com